

**Winnebago County, IL
GPS PROJECT 2000**

Station Name WIN 18.2N-03.3W Station No. 0088

Section 21, Town 28 North, Range 11 (East) West

Town of HARRISON, County Winnebago, State Illinois

Observer D. MUENCH; Date of observation 10.13.2000

Order of Control 1ST -Meters - Feet Zone: IL WEST

County Coordinates: N: 638211.791 LAT: 42 24 41.63238 N

H. Datum: NAD 83/91 E: 776311.082 LON: 89 14 22.38478 W

V. Datum: NAVD 88 ELEV: 243.220 ELLIP: 209.710 GH '99 -33.51

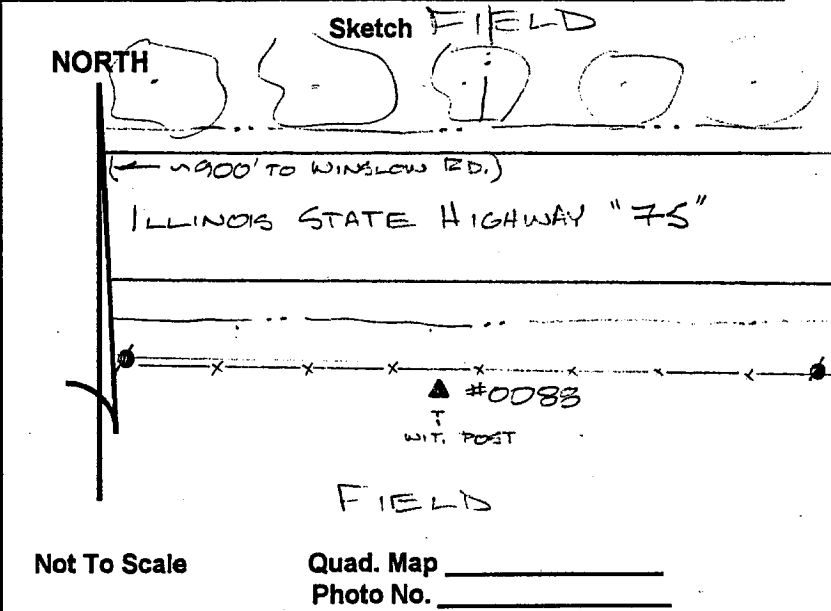
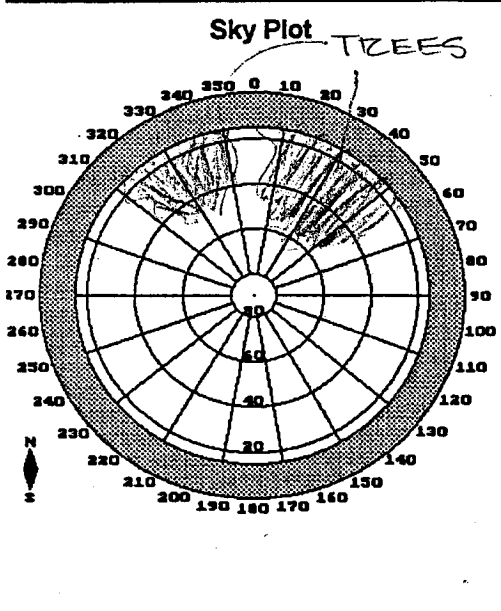
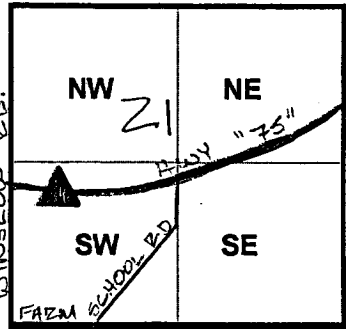

Not To Scale

Quad. Map _____
Photo No. _____

DESCRIPTION: POINT 0088 IS A STAINLESS STEEL ROD SET 0.3' BELOW GED. IN A HAND-HOLE, LOCATED ~30' S/O ILLINOIS STATE HIGHWAY "75" ~900' E/O WINSLOW RD.