

**Winnebago County, IL
GPS PROJECT 2000**

Station Name WIN 20.5N-03.2W A Station No. 87A

Section 9, Town 28 North, Range 11 East / West

Town of Harrison, County Winnebago, State Illinois

Observer C. Trickett; Date of observation 21 Nov. 2000

Order of Control 1ST -Meters -Feet Zone: IL WEST

County Coordinates: N: 641980.406 LAT: 42 26 43.85089 N

H. Datum: NAD 83/91 E: 776051.344 LON: 89 14 31.94932 W

V. Datum: NAVD 88 ELEV: 222.950 ELLIP 189.390 GH '99 -33.56

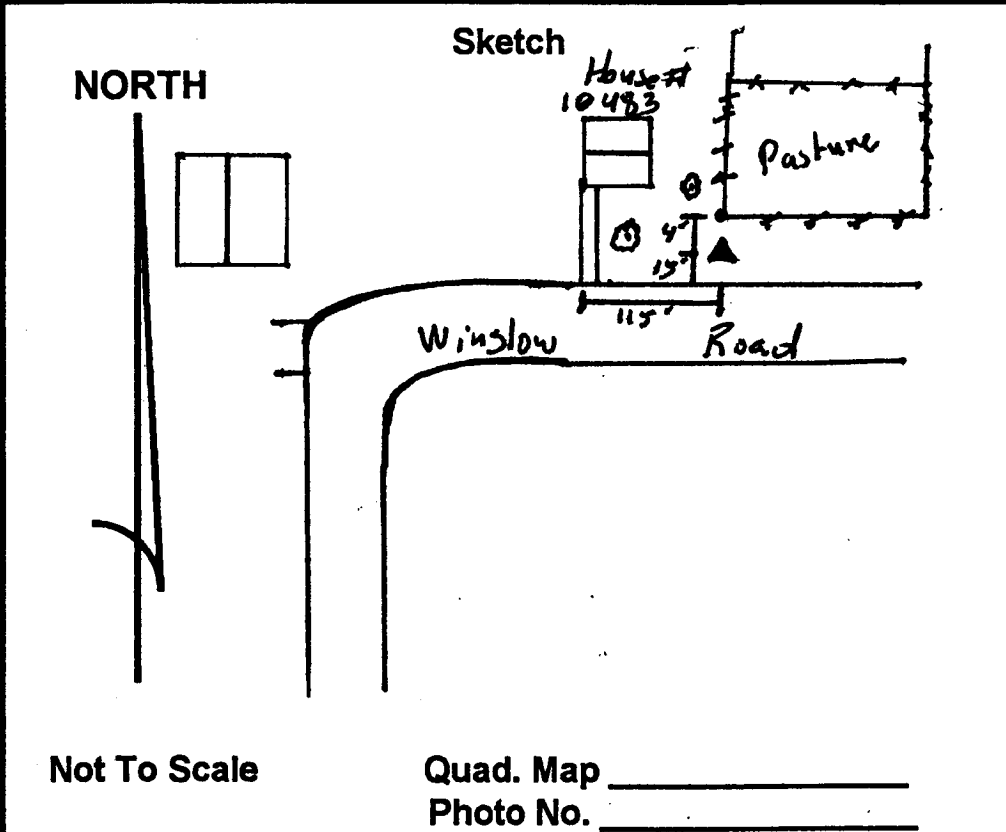
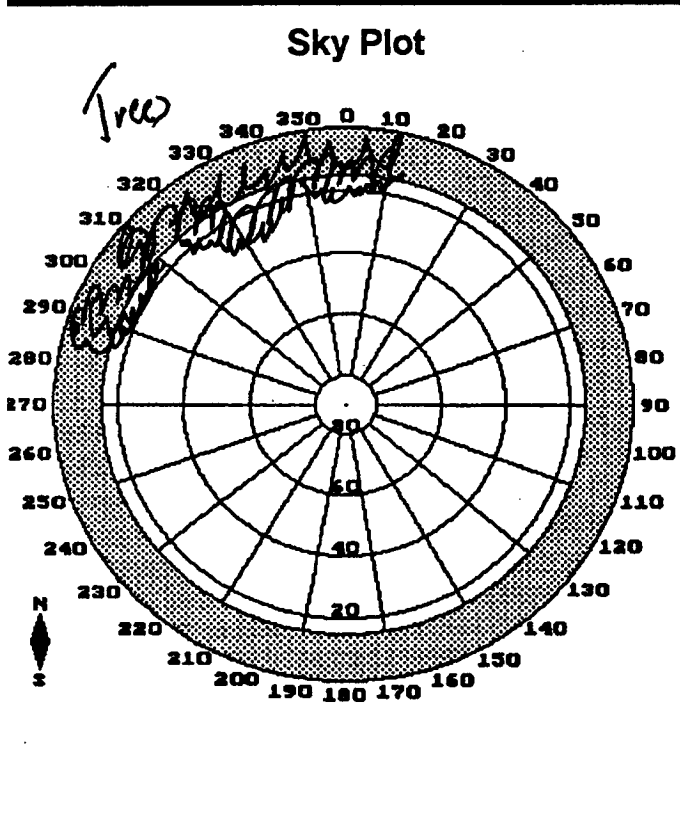
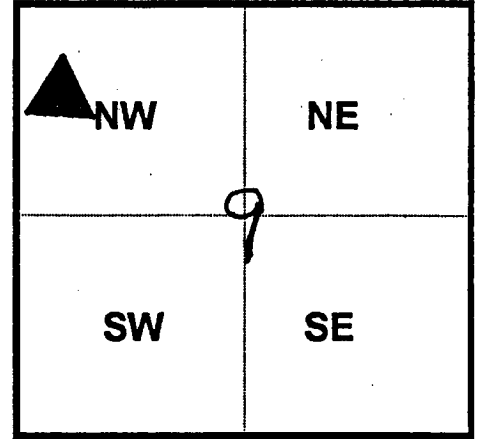

DESCRIPTION: Station is a stainless steel rod in PVC pipe. Station is 0.9 miles west of Hawley Road, 15 feet North of the North EOP of Winslow Road, 4 feet South of the Southwest land corner post of Barbed wire fence, and 1 foot South of an orange Larsonite witness post, and 115 feet East of the Center of P.E. Number "10483."