

**Winnebago County, IL
GPS PROJECT 2000**

Station Name WIN 15.2N 09.3E Station No. 21

Section 22, Town 45 North, -Range 2 East West

Town of Harlem, County Winnebago, State Illinois

Observer E. Lindas; Date of observation 10/17/00

Order of Control 1ST -Meters - Feet Zone: II WEST

County Coordinates: N: 633751.537 LAT: 42 22 08.99671 N

H. Datum: NAD 83/91 E: 796546.940 LON: 88 59 40.18131 W

V. Datum: NAVD 88 ELEV: 259.620 ELLIP 226.110 GH '99 -33.51

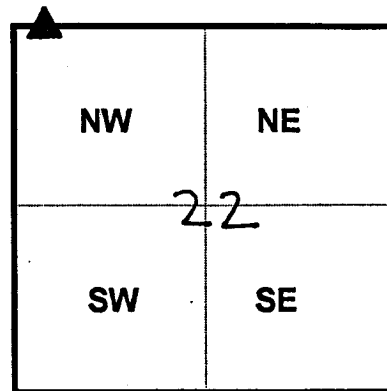

Sky Plot

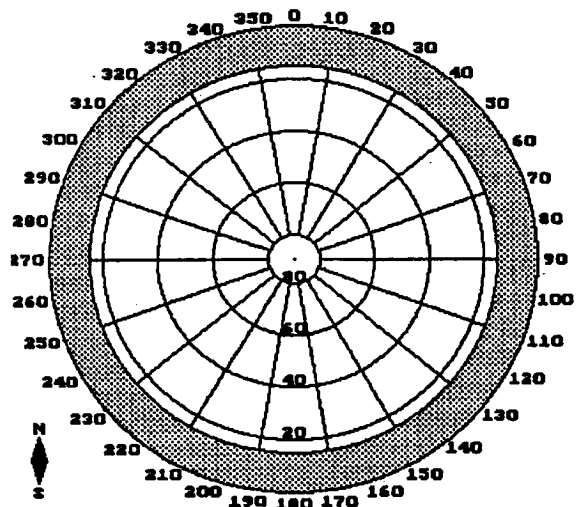

Clear

Sketch

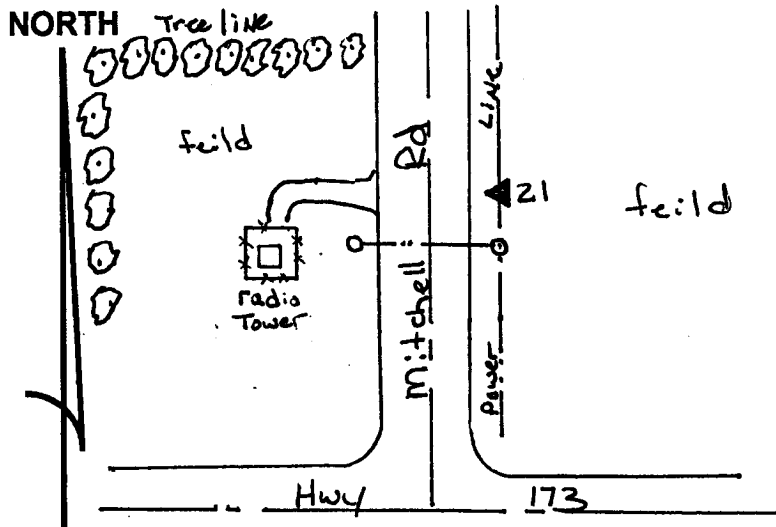

Not To Scale

Quad. Map _____
Photo No. _____

DESCRIPTION: Steel rod & Al cap located 0.2 mile North of Hwy 173 E Mitchell Rd.; North 50'± of Power Pole; 30'± East of East edge of bit (extension of North edge of PE to radio tower); 5' (3 feet West of Witness post at top of bank); Al cap at ground level.