

Station No. _____

**Winnebago County, IL
GPS PROJECT 2000**

Station Name Win 17.4N-07.9W A Station No. 109 A

Section 27, Town 28 North, Range 10 East/ West

Town of DuRand, County Winnebago, State Illinois

Observer S. Trisloff; Date of observation: 21 Nov. 2003

Order of Control 1ST -Meters - Feet Zone: IL WEST

County Coordinates: N: 637340.773 LAT: 42 24 15.81414 N

H. Datum: NAD 83/91 E: 769165.826 LON: 89 19 35.23904 W

V. Datum: NAVD 83 ELEV: 271.580 ELLIP: 238.140 GH '99: -33.44

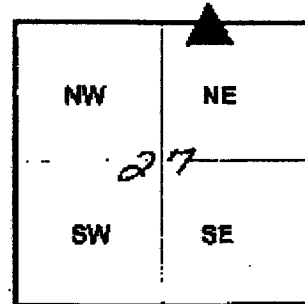

Sky Plot

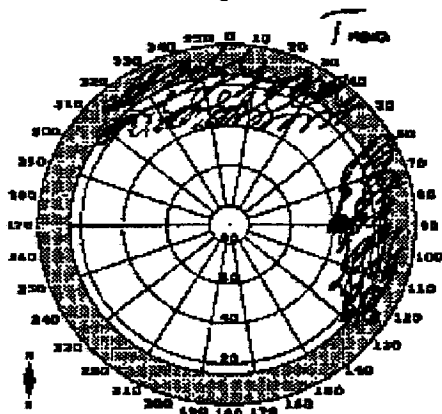

NORTH

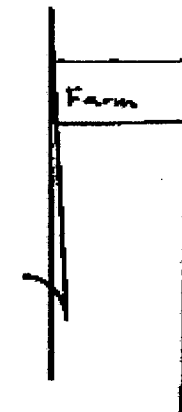

Not To Scale

Sketch

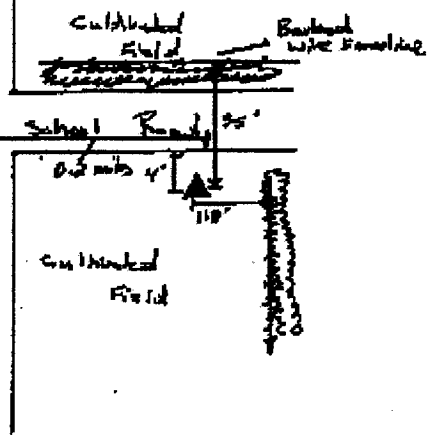

Quad. Map _____
Photo No. _____

DESCRIPTION: Station is a stainless steel rod in PVC pipe. Station is 0.2 miles East of Center Road, 4 feet South of the South E.P. of Farm School Road, 35 feet South of a East/West running barbed wire fence, 110 feet West of a Steel rod post to North/South running fence, and 1 foot South North of an orange Carsmile witness post.