

**Winnebago County, IL
GPS PROJECT 2000**

Station Name WIN 18.6N-05.5W A Station No. 189A

Section 19, Town 28 North, Range 11 East / West

Town of Harrison, County Winnebago, State Illinois

Observer C. Trueloff; Date of observation 21 Nov. 2000

Order of Control 1ST -Meters - Feet Zone: IL WEST

County Coordinates: N: 638822.577 LAT: 42 25 02.45148 N

H. Datum: NAD 83/91 E: 773354.201 LON: 89 16 31.41402 W

V. Datum: NAVD 88 ELEV: 268.930 ELLIP 235.430 GH '99 -33.50

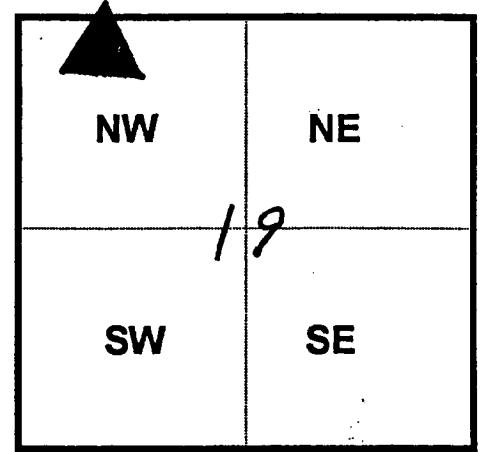

Sky Plot

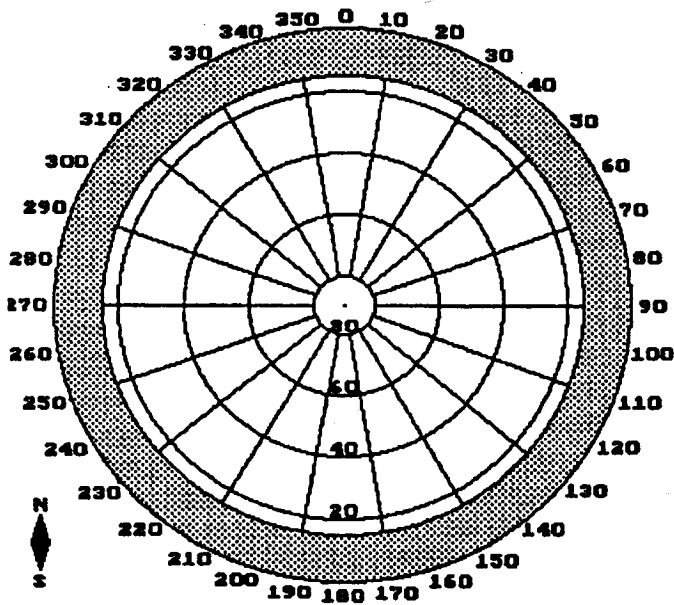

Clear

Sketch

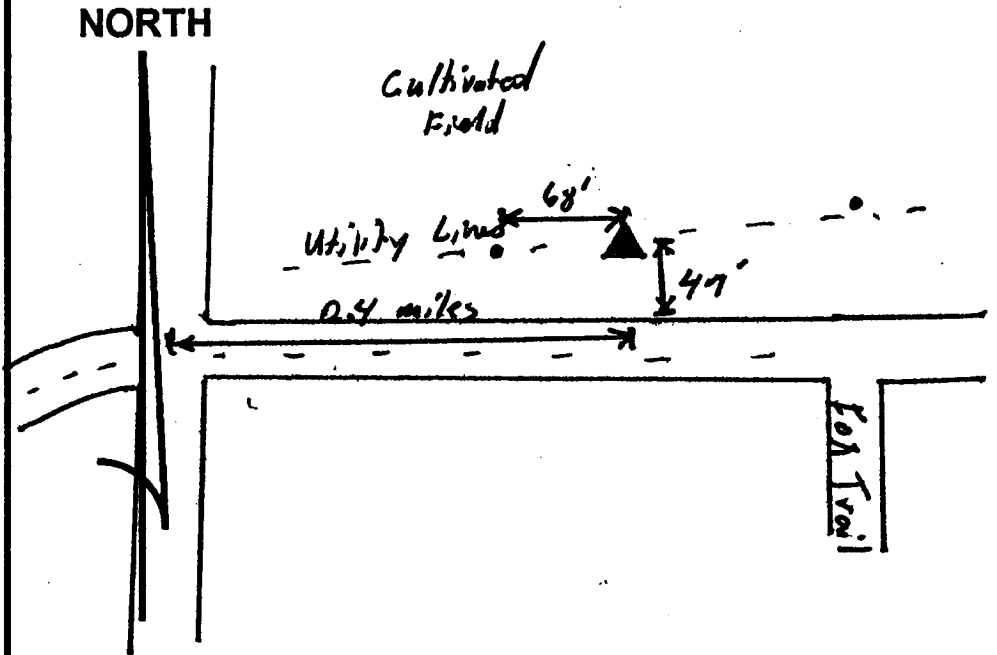

Not To Scale

Quad. Map _____
Photo No. _____

DESCRIPTION: Station is a stainless steel rod in PVC pipe. Station is 0.4 miles East of Wheeler Road, 68 feet East of "Utility pole" CA 68 SPR 0" 47 feet North of the North EOP of SH 175 (Freeman Road), and 1 foot South of an orange concrete witness post.